

The most robust cleaver

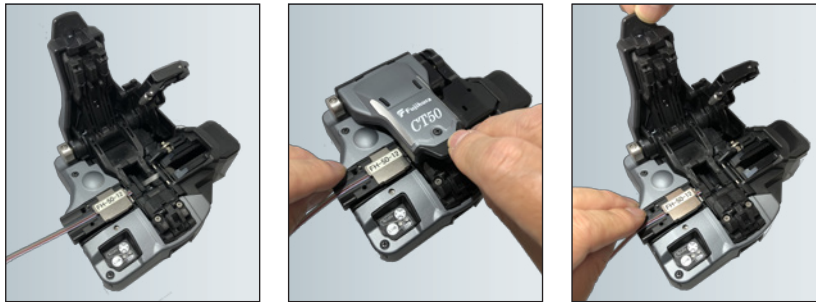

Fiber Cleaver

Fujikura CT50



- Applicable for up to 16-fiber cleaving
- Automatic cleaving blade rotation via wireless data communication
- User replaceable fiber clamps and cleaving blade
- Blade life up to 60,000 cleaves
- Wide lever opening angle allows easy fiber placement
- Single-action operation including fiber scrap collection

Newly Installed



Fujikura CT50

SPECIFICATIONS

Description	CT50
Applicable optical fiber	Silica optical fiber
Fiber count	Up to 16
Cladding diameter	125 µm
Coating diameter	160 to 900µm, 2 to 3mm cord and drop cable
Cleaving length	AD-10-M24 5mm to 20mm (coating diameter =250µm)
	AD-50 10mm to 20mm (coating diameter > 250µm)
	Fiber holder 10mm (from the edge of FH:13mm)
Cleaving angle*1	Typical 0.7 degrees with single fiber
Blade life	Typical 60,000 fibers
Wireless data communication	Wireless technical standard:Bluetooth® 4.1 LE*2 OS : Android 5.0 or above, iOS 8.0 or above (iPhone6 above)
Power supply	AAA (LR03) dry battery: 2pcs
Dimensions / Weight	120(W)x95(D)x58(H)mm / 300g (including battery)
Operation condition	Temperature : -10 to 50deg C Humidity : less than 95%RH, non-dew
Storage condition	Temperature : -40 to 80deg C Humidity : less than 95%RH, non-dew
Resistance features*3	Shock: 76cm (30inch) all directions drop
	Dust resistance: Exposure to dust (0.1 to 500µm dia. Alumina Silicate)
	Rain resistance: H=10mm/hr for 10min

*1 The optical fiber type, the blade condition or the operating environment may affect the cleaving angle. Since the measuring device has been changed from an interference microscope to a fusion splicer, this specification value is now higher than that of the previous model (CT-30).

*2 The wireless data communication of this product is not guaranteed to work with all smartphones or other devices.

*3 The shock, dust and rain resistance test does not guarantee the product will not be damaged under these conditions.

• Bluetooth® and Bluetooth logo is a registered trademark of Bluetooth SIG, Inc.



STANDARD PACKAGE

Description	Model No.	Q'ty
Fiber cleaver	CT50	1pc
Fiber plate	AD-10-M24	1pc
Fiber plate	AD-50	1pc
Spacer	SPA-CT08-10	1pc
Carrying case	CC-37	1pc
Hexagonal wrench	HEX-01	1pc
Instruction manual	M-CT50-E	1pc

OPTIONAL ITEMS

Description	Model No.
Blade	CB-08
Arm set	ARM-CT50-01
Dust box	FDB-05
Side cover	SC-CT50-01

STANDARD PACKAGE

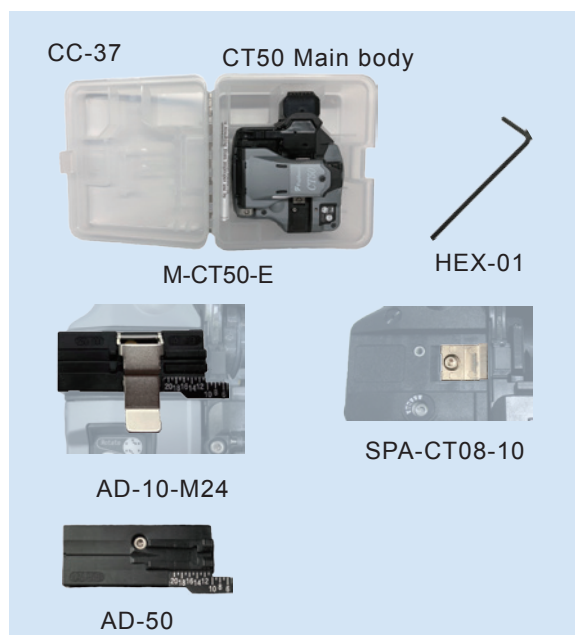

OPTIONAL ITEMS



FIBER HOLDERS

Description	Model No.
Applicable fiber holder*4	FH-70-xxx
	FH-100-xxx

*4 It is available to use previous fiber holder "FH-50"series and "FH-60"series

913·10-0842-142·95-02 Printed in Japan 1805-1902-500-JCC

überreicht durch: Opternus GmbH · Bahnhofstraße 5 · 22941 Bargteheide | Tel.: +49 (0) 4532 20 44 - 0 | info@opternus.de | www.opternus.de